

**Report to the Chief Officer (Highways and Transportation)**

**Date: 19 July 2016**

**Subject: Approval for the Construction of a Flood Alleviation Scheme at Glebelands Recreation Ground, Garforth.**

**Capital Scheme Number : 32234**

Are specific electoral Wards affected? If relevant, name(s) of Ward(s): Garforth and Swillington	<input checked="" type="checkbox"/> Yes	<input type="checkbox"/> No
Are there implications for equality and diversity and cohesion and integration?	<input type="checkbox"/> Yes	<input checked="" type="checkbox"/> No
Is the decision eligible for Call-In?	<input type="checkbox"/> Yes	<input checked="" type="checkbox"/> No
Does the report contain confidential or exempt information? If relevant, Access to Information Procedure Rule number: Appendix number: <b>N/A</b>	<input type="checkbox"/> Yes	<input checked="" type="checkbox"/> No

**Summary of main issues**

1. There is a long history of pluvial flooding in the Glebelands recreation ground area with three properties experiencing internal flooding on more than one occasion.
2. The flood risk can be reduced through flood alleviation works within Glebelands recreation ground by the construction of an embankment to increase flood storage capacity of the site in times of heavy rainfall.
3. The benefits of the proposed scheme will be a significant reduction in the risk of flooding to 10 residential properties and Ninelands Primary School. It will also attenuate surface water flow, reducing flood risk marginally to residential properties along with roads, to the downstream catchment.
4. The site is listed as number 4 in the List of Measures in the Leeds Local Flood Risk Management Strategy.
5. The Glebelands Flood Alleviation scheme meets Leeds Best Council Plan by supporting communities; Keeping people safe from harm.

**Recommendations**

6. The Chief Officer (Highways and Transportation) is requested to:

- i) approve the implementation of the Glebelands Flood Alleviation scheme at Glebelands recreation ground, shown on drawing FRM/253260/CON/004; and
- ii) give authority to incur expenditure of £90,000 on the Glebelands Flood Alleviation scheme, funded from the LCC FRM capital budget £33,000 and Government Grants £57,000.

## **1 Purpose of this report**

- 1.1 To note the issues with flooding the Glebelands area in Garforth where residential properties and Ninelands Lane Primary School are at risk from pluvial flooding.
- 1.2 To give authority to incur expenditure on the proposed flood alleviation works.

## **2 Background Information**

- 2.1 There is a long history of flooding in the Glebelands Recreation Ground area. Two residential properties flooded internally in 2007 & 2014 from surface water flows over spilling from the corner of the playing field into their properties. One residential property was flooded internally in 2002, 2005, 2006 & 2014 from water over spilling from the highway. These flooding instances also caused localised flooding of the highway network at Ninelands Lane and flooding to Ninelands Primary School.
- 2.2 Flooding incident reports indicate the source of the flooding is a combination of flows from the playing fields and surface water runoff from the Ninelands Lane and the adjacent industrial area.
- 2.5 The properties at risk and key site features are shown on Figure 2.

## **3 Main Issues**

- 3.1 The proposed flood alleviation scheme is shown on drawing number: FRM/253260/CON/004. The scheme involves construction of an embankment and excavation of a borrow pit to extend the existing flood storage capacity of the site. Excavation of 750m<sup>3</sup> of clay will be required to construct an embankment 260m long between 0.25m and 1.2m high to retain flood waters in times of heavy rainfall. Additional works will be required to direct flows into the newly created flood storage area, including amendments to the school boundary fence, creation of swales, gravel filter drain and a new outlet headwall.
- 3.2 The ground conditions on site are typically topsoil and Made Ground overlying Clay overlying mudstone & sandstone bedrock and are suitable for the proposed construction works.
- 3.3 The benefits of the proposed scheme will be a significant reduction in the risk of flooding to 10 residential properties and Ninelands Primary School. It will also reduce flood risk marginally to an additional 37 residential properties along with roads and businesses in the downstream catchment.
- 3.3 Full planning permission for the scheme was approved on 17<sup>th</sup> December 2015. Application Ref 15/06080/LA.

- 3.4 Glebelands Recreation Ground is in the council ownership and is vested to Parks and Countryside.
- 3.5 There are no buried or overhead utility services that conflict with the proposed works. A preparatory ecological survey has also been undertaken.
- 3.6 It is intended to undertake the works in the 2016/17 financial year.

## **4 Corporate Considerations**

### **4.1 Consultation and Engagement**

- 4.1.1 Regular consultation and engagement has been carried out with local residents, the Garforth Flood Action Group, Ward Councillors, Ninelands Primary School, the Environment Agency and Park & Countryside as landowners. Newsletters and project updates will be distributed as the scheme progresses.
- 4.1.4 Further engagement will take place as the scheme is constructed. Ninelands Primary school have expressed an interest in using the scheme and concept to educate pupils.
- 4.1.5 The scheme was included in the public consultation on the Local Strategy for Flood Risk Management for Leeds City Council.

### **4.2 Equality and Diversity / Cohesion and Integration**

- 4.2.1 An EDCI screening has been completed and is attached as Appendix B. This indicated that an Equality Impact Assessment is not required for what is being proposed.
- 4.2.2 It should be noted that by carrying out these works the Council will be ensuring the safety of the local community and in particular more vulnerable residents such as those who are elderly or have a disability and may struggle to get to safety if flooding occurred.

### **4.3 Council policies and City Priorities**

- 4.3.1 The proposed works will provide improvements to the community and the neighbourhood by reducing the risk of flooding to this area.
- 4.3.2 The Council is meeting its responsibility as Lead Local Flood Authority in reducing flood risk.
- 4.3.3 This scheme is in accordance with the Councils Local Flood Risk Management Strategy and is considered as one of the high priority schemes within the List of Measures to be taken.

### **4.4 Resources and value for money**

- 4.4.1 The total estimated scheme cost is £90,000. This comprises £20,000 for staff design and construction supervision costs, £10,000 for site investigations and surveys, and £60,000 for the main construction works.

4.4.2 The scheme cost will be funded from 3 sources: Environment Agency Contributions: Flood Defence Grant in Aid (FDGiA) – £37,000, Local Levy - £20,000, LCC FRM CAPITAL – £33,000

#### 4.5 Capital Funding and Cash Flow

Funding Approval :	Capital Section Reference Number :-						
Previous total Authority to Spend on this scheme	TOTAL	TO MARCH	FORECAST				
	£000's	2015 £000's	2015/16	2016/17	2017/18	2018/19	2019 on
			£000's	£000's	£000's	£000's	£000's
LAND (1)	0.0						
CONSTRUCTION (3)	0.0						
FURN & EQPT (5)	0.0						
DESIGN FEES (6)	0.0						
OTHER COSTS (7)	0.0						
<b>TOTALS</b>	<b>0.0</b>	<b>0.0</b>	<b>0.0</b>	<b>0.0</b>	<b>0.0</b>	<b>0.0</b>	<b>0.0</b>
Authority to Spend required for this Approval	TOTAL	TO MARCH	FORECAST				
	£000's	2015 £000's	2015/16	2016/17	2017/18	2018/19	2019 on
			£000's	£000's	£000's	£000's	£000's
LAND (1)	0.0						
CONSTRUCTION (3)	60.0			60.0			
FURN & EQPT (5)	0.0						
DESIGN FEES (6)	30.0			30.0			
OTHER COSTS (7)	0.0						
<b>TOTALS</b>	<b>90.0</b>	<b>0.0</b>	<b>0.0</b>	<b>90.0</b>	<b>0.0</b>	<b>0.0</b>	<b>0.0</b>
Total overall Funding (As per latest Capital Programme)	TOTAL	TO MARCH	FORECAST				
	£000's	2015 £000's	2015/16	2016/17	2017/18	2018/19	2019 on
			£000's	£000's	£000's	£000's	£000's
LCC Supported Borrowing	33.0			33.0			
Revenue Contribution	0.0						
Capital Receipt	0.0						
Government Grant	57.0			57.0			
Any Other Income ( Specify)	0.0						
<b>Total Funding</b>	<b>90.0</b>	<b>0.0</b>	<b>0.0</b>	<b>90.0</b>	<b>0.0</b>	<b>0.0</b>	<b>0.0</b>
<b>Balance / Shortfall =</b>	<b>0.0</b>	<b>0.0</b>	<b>0.0</b>	<b>0.0</b>	<b>0.0</b>	<b>0.0</b>	<b>0.0</b>

#### 4.6 Revenue Effects

4.6.1 The proposed flood alleviation works will be the responsibility of LCC and will need to be maintained over the anticipated 75 year design life. Post construction there will be a requirement for routine maintenance visits by the Council involving grass cutting, debris and silt clearance and minor repair works. It is estimated that these costs will be up to £500 per annum over the design life of the scheme; this equates to a Present Value (PV) whole life cost of £14,100.

4.6.2 The maintenance regime will be delivered by Leeds City Council in partnership with landowners.

#### 4.7 Legal Implications, Access to Information and Call In

4.7.1 The proposed works will reduce flood risk in South East Garforth. The content of the report is a Significant Decision and is not subject to Call In.

#### **4.8 Risk Management**

4.8.1 There is a low risk of potential overspend due to encountering unforeseen conditions during the construction works. However this risk has been mitigated substantially through the design and survey works already. Any overspend above this would have to be met from the LCC capital budget.

### **5 Conclusions**

5.1 The benefits of the proposed scheme will be a significant reduction in the risk of flooding to 10 residential properties and Ninelands Primary School. It will also reduce flood risk marginally to an additional 37 residential properties in the downstream catchment.

5.2 Environment Agency Grant in Aid funding and Local Levy Funding provides an opportunity to obtain significant match funding to the LCC FRM Capital budget to implement the works.

### **6 Recommendations**

6.1 The Chief Officer (Highways and Transportation) is requested to:

- i) approve the implementation of Glebelands Flood Alleviation scheme at Glebelands recreation ground, shown on drawings FRM/253260/CON/004; and
- ii) give authority to incur expenditure of £90,000 on the Glebelands Flood Alleviation scheme, funded from LCC FRM capital budget £33,000 and Government Grants £57,000.

### **7 Background documents<sup>1</sup>**

7.1 Appendix A – General Arrangement – Drawing Number: FRM/253260/CON/004

7.2 Appendix B – Equality Impact Assessment

7.3 Relevant figures and photographs, as referenced in the above report are provided below.

---

<sup>1</sup> The background documents listed in this section are available to download from the Council's website, unless they contain confidential or exempt information. The list of background documents does not include published works.



*Figure 1 – Flooding at Ninelands Lane June 2016*

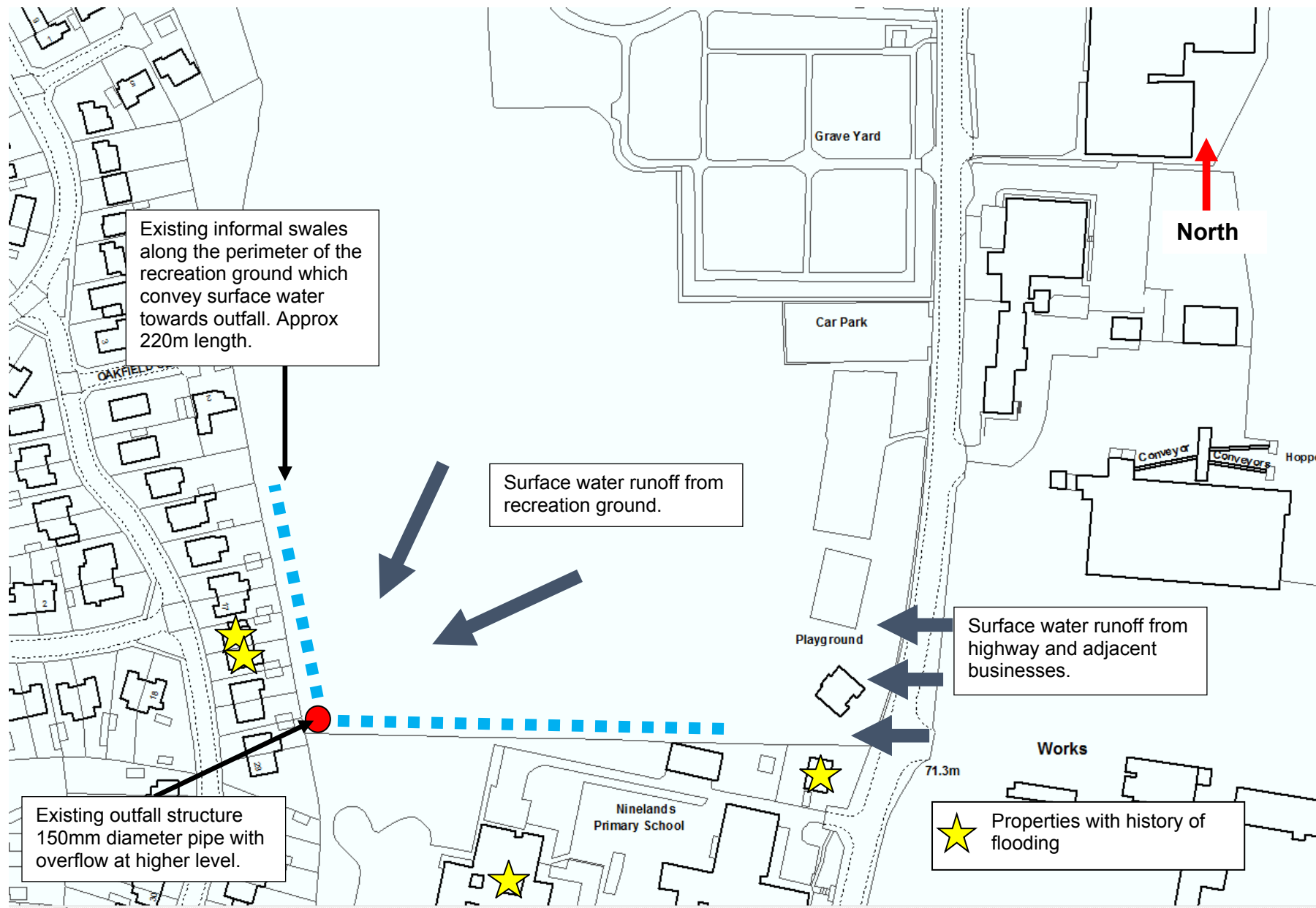

Figure 2 – Properties at risk and key site features - Glebelands Recreation Ground

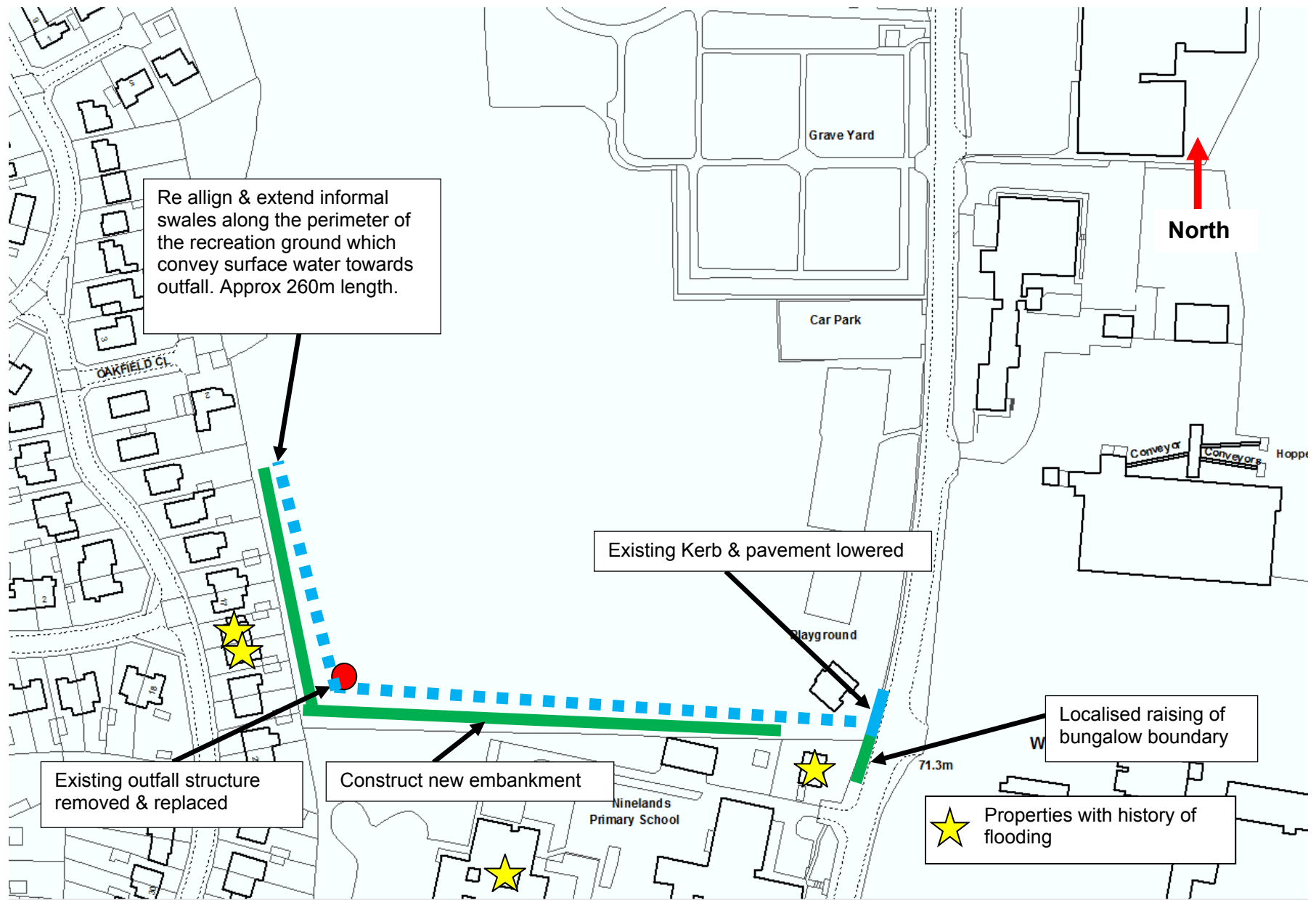

Figure 3 – Proposed measures - Glebelands Recreation Ground



## Appendix B

### Equality, Diversity, Cohesion and Integration Screening



As a public authority we need to ensure that all our strategies, policies, service and functions, both current and proposed have given proper consideration to equality, diversity, cohesion and integration.

A **screening** process can help judge relevance and provides a record of both the **process** and **decision**. Screening should be a short, sharp exercise that determines relevance for all new and revised strategies, policies, services and functions. Completed at the earliest opportunity it will help to determine:

- the relevance of proposals and decisions to equality, diversity, cohesion and integration.
- whether or not equality, diversity, cohesion and integration is being/has already been considered, and
- whether or not it is necessary to carry out an impact assessment.

<b>Directorate: City Development</b>	<b>Service area: Flood Risk Management</b>
<b>Lead person: Ian Hope</b>	<b>Contact number: 0113 395 2406</b>

#### 1. Title: Glebelands Recreation Ground - Flood Alleviation Scheme, Garforth

Is this a:

Strategy / Policy

Service / Function

Other

If other, please specify

#### 2. Please provide a brief description of what you are screening

**This EIA screening assessment is for the proposed flood alleviation works at Glebelands recreation Ground in Garforth. The works involve the construction of Flood Alleviation infrastructure which will reduce the risk of flooding to residential properties in South East Garforth.**

**The works comprise small scale landscaping to support the temporary storage of surface water during high intensity rainfall. The works also include associated headwall structures, swales & piped culverts in conjunction with the earthworks.**

### **3. Relevance to equality, diversity, cohesion and integration**

All the council's strategies/policies, services/functions affect service users, employees or the wider community – city wide or more local. These will also have a greater/lesser relevance to equality, diversity, cohesion and integration.

The following questions will help you to identify how relevant your proposals are.

When considering these questions think about age, carers, disability, gender reassignment, race, religion or belief, sex, sexual orientation and any other relevant characteristics (for example socio-economic status, social class, income, unemployment, residential location or family background and education or skills levels).

<b>Questions</b>	<b>Yes</b>	<b>No</b>
Is there an existing or likely differential impact for the different equality characteristics?		x
Have there been or likely to be any public concerns about the policy or proposal?		x
Could the proposal affect how our services, commissioning or procurement activities are organised, provided, located and by whom?		x
Could the proposal affect our workforce or employment practices?		x
Does the proposal involve or will it have an impact on <ul style="list-style-type: none"> <li>• Eliminating unlawful discrimination, victimisation and harassment</li> <li>• Advancing equality of opportunity</li> <li>• Fostering good relations</li> </ul>		x

If you have answered **no** to the questions above please complete **sections 6 and 7**

If you have answered **yes** to any of the above and;

- Believe you have already considered the impact on equality, diversity, cohesion and integration within your proposal please go to **section 4**.
- Are not already considering the impact on equality, diversity, cohesion and integration within your proposal please go to **section 5**.

#### 4. Considering the impact on equality, diversity, cohesion and integration

If you can demonstrate you have considered how your proposals impact on equality, diversity, cohesion and integration you have carried out an impact assessment.

Please provide specific details for all three areas below (use the prompts for guidance).

- **How have you considered equality, diversity, cohesion and integration?**

(**think about** the scope of the proposal, who is likely to be affected, equality related information, gaps in information and plans to address, consultation and engagement activities (taken place or planned) with those likely to be affected)

- **Key findings**

(**think about** any potential positive and negative impact on different equality characteristics, potential to promote strong and positive relationships between groups, potential to bring groups/communities into increased contact with each other, perception that the proposal could benefit one group at the expense of another)

- **Actions**

(**think about** how you will promote positive impact and remove/ reduce negative impact)

5. If you are **not** already considering the impact on equality, diversity, cohesion and integration you **will need to carry out an impact assessment**.

Date to scope and plan your impact assessment:	
Date to complete your impact assessment	
Lead person for your impact assessment (Include name and job title)	

#### 6. Governance, ownership and approval

Please state here who has approved the actions and outcomes of the screening

Name	Job title	Date
Ian Hope	Group Engineer	20/06/16

## 7. Publishing

This screening document will act as evidence that due regard to equality and diversity has been given. If you are not carrying out an independent impact assessment the screening document will need to be published.

Please send a copy to the Equality Team for publishing

<b>Date screening completed</b>	20/06/16
<b>If relates to a Key Decision send to Corporate Governance</b>	
<b>Any other decision please send to Equality Team (equalityteam@leeds.gov.uk)</b>	